

## ABOUT US

JG Innovations, Inc. is the #1 source for USA made steel soffit enclosure systems. Contributing to the industry for more than 30 years, we possess the expertise required to efficiently handle your unique pipe and mechanical enclosure requirements. We take pride in our systems' design and integrity and are confident that you'll be fully satisfied.

## PRODUCTS WITH UNEQUALED PROTECTION & SECURITY

**JG Innovations' Soffi-Steel<sup>®</sup>, Interlock<sup>™</sup> and ALumA-Fit<sup>™</sup> Concealment Systems** are the ideal solution for properly protecting your exposed pipe and mechanicals from accidental damage or vandalism. The need to not only properly guard the exposed pipe or mechanicals, but to keep them out of sight and aesthetically pleasing may be equally important for owners. JG Innovations, Inc. works closely with specifiers and contractors to minimize disruptions and stay on schedule.

**JG Innovations' concealment systems are the only UL Listed, FM Approved, Patented Enclosures on the Market.** Our soffit concealment systems are specified by architects and engineers nationwide to enclose exposed pipe and mechanicals in:

- Universities
- College Dormitories
- Student Housing
- PK-12 Schools
- Nursing Homes
- Assisted Living Communities
- VA Hospitals and Clinics
- Psychiatric Facilities
- Detention Centers
- Jails and Prisons
- Affordable Housing
- High-Rises/Condominiums
- Residential Properties
- Commercial Buildings

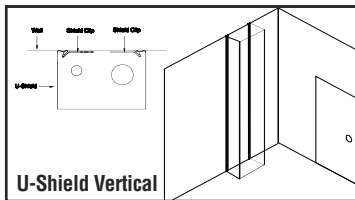
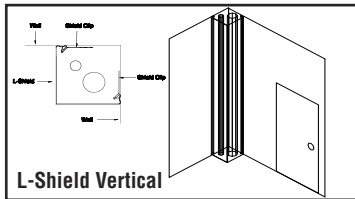
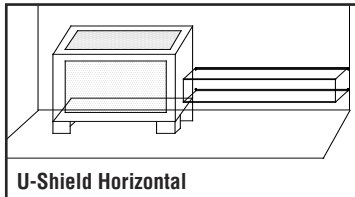

## Your First Source For Innovative Interior Soffit Solutions

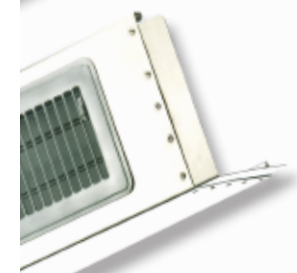

**UNIVERSITIES  
COMMERCIAL  
RESIDENTIAL  
CORRECTIONAL**

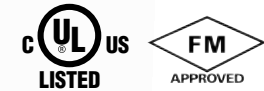

## OUR INNOVATIVE SYSTEMS



**888.933.2248**

**www.JGIUS.com • sales@jgius.com**



## SOFFIT IS FABRICATED TO ANY SIZE, ANY DIMENSION, FOR ANY SITUATION

# EASY AS

### 1. SELECT THE PROFILE: SIZE OF THE PIPE DOESN'T MATTER

Choose the L-Shield profile when two sides of your pipe or mechanical need to be covered.

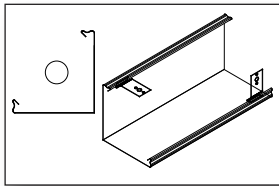

Choose the U-Shield profile when three sides of your pipe or mechanical need to be covered.

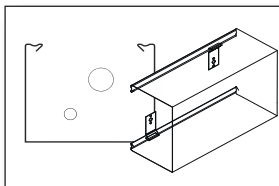

Choose the Slope-Top profile for aesthetic purposes or to discourage the use of the cover as a sitting area.

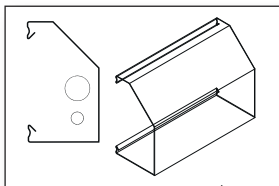

#### CUSTOM SHAPES AND PROFILES AVAILABLE

#### WILL YOU NEED AN ACCESS PANEL?

Yes  No



### 2. TELL US THE SIZE YOU NEED

Height: \_\_\_\_\_  
Choose between 3" and 60"

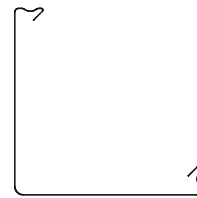

Width: \_\_\_\_\_  
Choose between 3" and 60"

Height: \_\_\_\_\_  
Choose between 3" and 60"

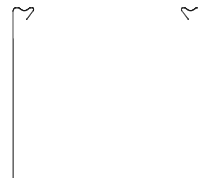

Height: \_\_\_\_\_  
Choose between 3" and 60"

Width: \_\_\_\_\_  
Choose between 3" and 60"

#### TELL US THE LENGTH YOU NEED

\_\_\_\_\_ 8' \_\_\_\_\_ 10'

\_\_\_\_\_ Other/Cut to Exact Length at \_\_\_\_\_"

### 3. SELECT THE MATERIAL, GAUGE AND COLOR YOU REQUIRE:

All configurations can be manufactured in light to heavy-duty 24-16 Gauge A60/G90 Galvannealed Steel, Stainless Steel or .050 Aluminum to accommodate any installation requirement.

\_\_\_\_\_ 24 Gauge    \_\_\_\_\_ 20 Gauge    \_\_\_\_\_ 16 Gauge  
(22 and 18 gauge can be quoted)  
\_\_\_\_\_ 304 Stainless Steel    \_\_\_\_\_ .050 Aluminum

#### TELL US THE FINISH/COLOR YOU'D LIKE:

Sherwin Williams epoxy hybrid powder coating in colors:

\_\_\_\_\_ Pure White    \_\_\_\_\_ Dover White  
\_\_\_\_\_ Off White    \_\_\_\_\_ Antique White

\_\_\_\_\_ Zinc-Galvannealed (Unfinished)

\_\_\_\_\_ White Primer

\_\_\_\_\_ Stainless Steel, #4 Finish

Call 888.933.2248

Email [sales@jgius.com](mailto:sales@jgius.com) or  
learn more at [www.JGIUS.com](http://www.JGIUS.com)

